

TANDEM – Führungssystem

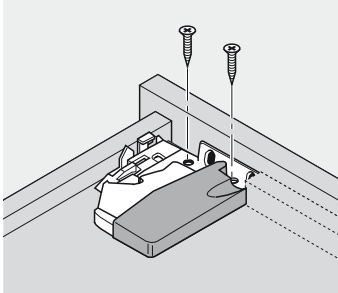

- ▶ TANDEM – Grundelement
- ▶▶ Montage, Demontage und Verstellung

Kupplung



Vierseitiger Schubkasten

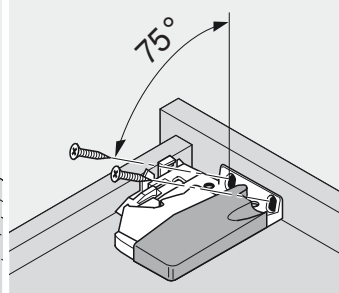

Dreiseitiger Schubkasten

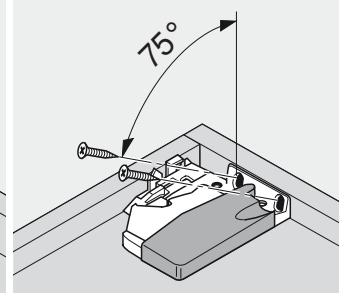

Innenschubkasten

Verstellung

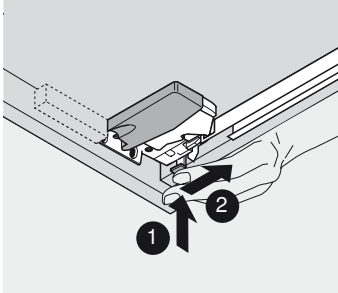

Verstellung Höhe: + 3 mm

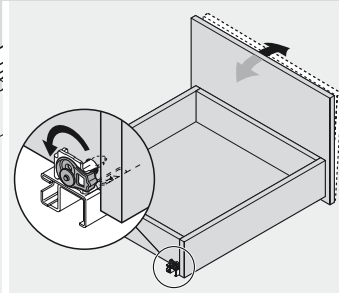

560/566/561: Neigung über Führung

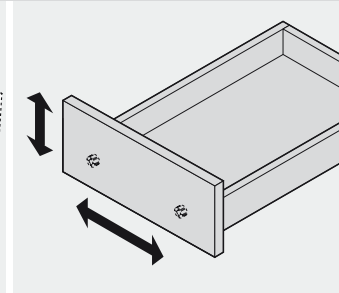

Verstellung Höhe/Seite über Frontverstellbeschlag ± 2 mm

Frontauszug

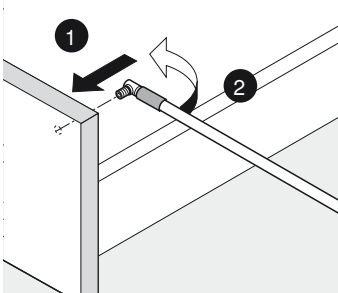

Montage vorne

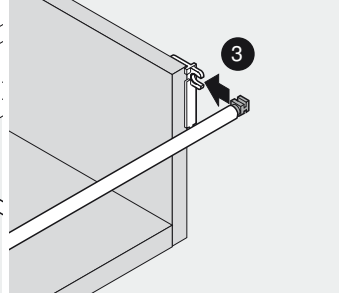

Montage hinten

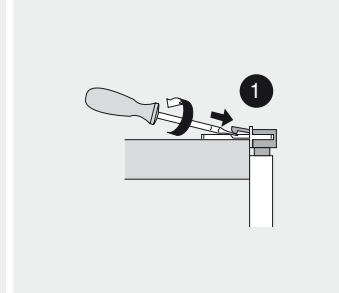

Demontage hinten

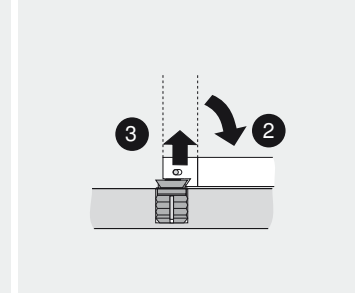

Demontage vorne

Schubkasten ein- und aushängen (560H/566H/550H)

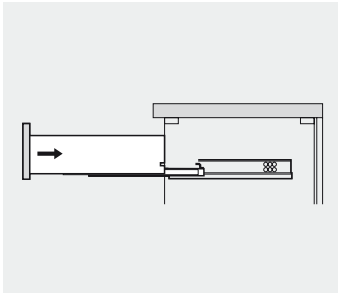

Einhängen

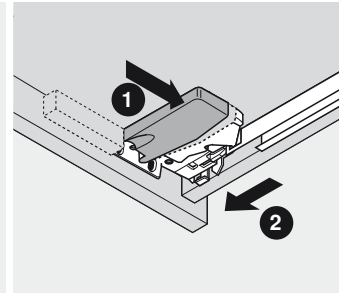
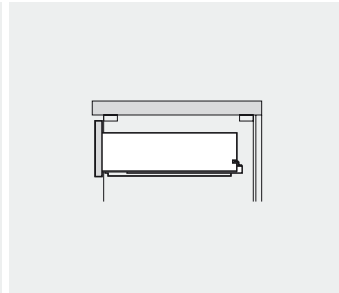

Aushängen

